



AV Series Dynamic Mounting Arm

Tilt, Swivel and Swing

- **Intuitive grab and move operation enhances the user experience**

No knobs or tools required to reposition the display

Precise control of operating effort ensures ideal “feel” and eliminates “drift”

Holds securely, even in applications with dynamic loading

- **Low profile in the stowed position**

Folds to within 50 mm of the wall

- **Snap-open channels simplify wire management**

Easy display installation and replacement

- **Factory assembled and ready for use**

Product Detail

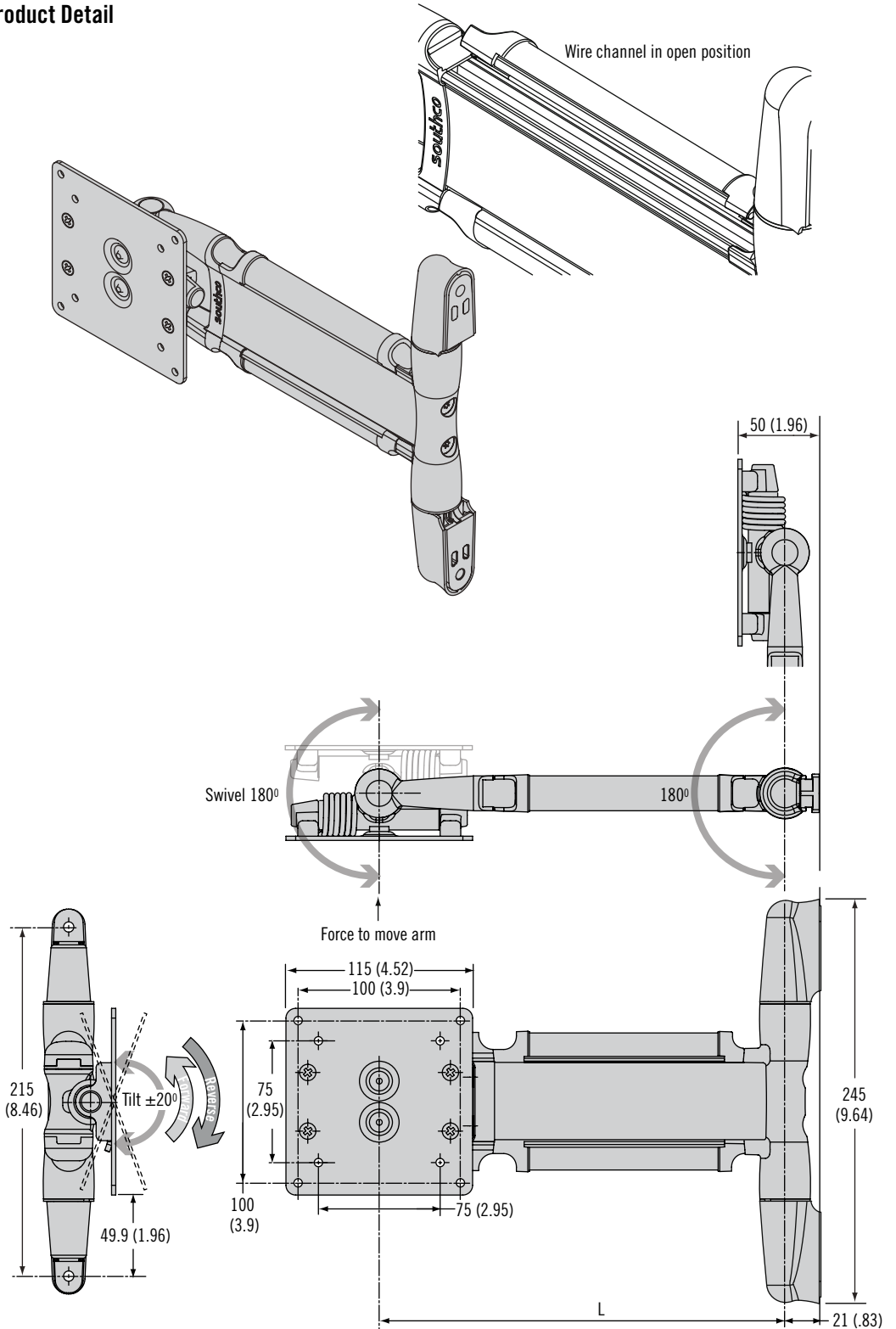

VESA MIS-D, 100, C



www.southco.com/AV

Dimensions in millimeters (inch) unless otherwise stated

southco
CONNECT · CREATE · INNOVATE

AV Series Dynamic Mounting Arm

Tilt, Swivel and Swing

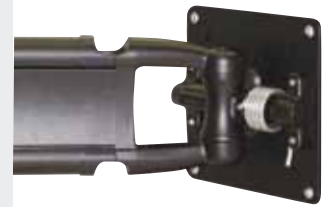

Specification and Selection

Step 1

Determine display weight and distance (d) from mounting surface to center of gravity.

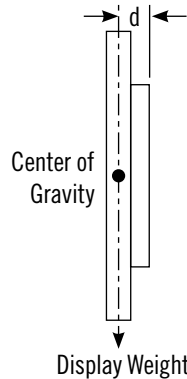

Step 2

Use chart below to select model (101 or 102).

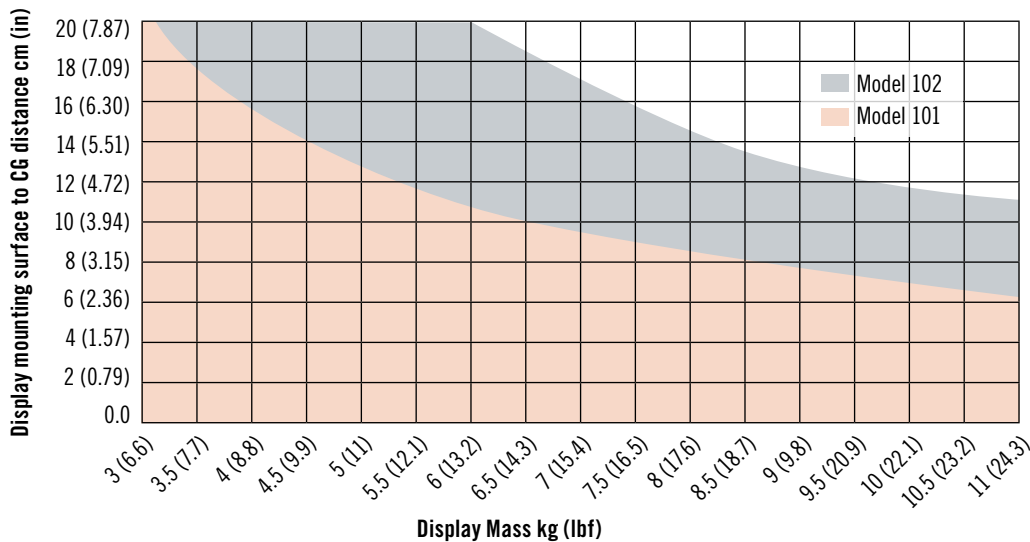

Step 3

Complete part number by selecting length and color options below.

K	Length (L)	Average ultimate load N (lbf)
15	150 (5.9)	1780 (400)
25	250 (9.8)	1560 (350)
35	350 (13.8)	1000 (225)
45	450 (17.7)	890 (200)

Model S	Force to move arm N (lb)	Tilt Torque N•m (in lbf)		Swivel Torque
		Reverse	Forward	
101	22.2 (5)	7.9 (70)	1.13 (10)	2.3 (20)
102	33.8 (7.6)	15.4 (136)	2.26 (20)	3.4 (30)

F	Color
50	Black
76	White

AV - D30 - **K** A **S** - **F**

- Smooth operation enhances the user experience
- Adjust the display without knobs or tools
- Holds securely in every position

Material and Finish

Aluminum alloy, powder coated

Performance Details

Cycle performance: 20,000 cycles within $\pm 20\%$ of static torque specification

Max. dynamic working load:

Model 101: 66N (15 lbf)

Model 102: 98N (22 lbf)

Average ultimate load: See table

Part Number

See table

Part Number Example

AV-D30-25A101-50 = Dynamic mounting arm, Model 101, 250mm Length, black



AV Series Dynamic Mounting Arm

Tilt, Swivel and Swing

- Smooth operation enhances the user experience
- Adjust the display without knobs or tools
- Holds securely in every position

Installation

1. Determine desired mounting location
2. Mark upper and lower mounting holes. For ideal hole location, mark upper hole first, then use a plumb line to ensure vertical orientation between the upper and lower holes
 - a. For thru-bolt installation, drill or punch holes as indicated on trade drawing and install using 1/4-20 or M6 screws.
 - b. For installation in wood studs, drill a 3/16 inch pilot hole and install using a 1/4 inch lag bolt. Do not over tighten.
 - c. For compliant mounting surfaces (gypsum board, etc.) use optional wall plate, sold separately.

Caution: Because of the wide variety of available wall materials, it is the installer's responsibility to ensure that the materials, and structure to which the arm is mounted, and the hardware selected will provide adequate support.

3. Slide on mounting hardware covers and attach display using manufacturer's recommended hardware.
4. Route wiring as needed

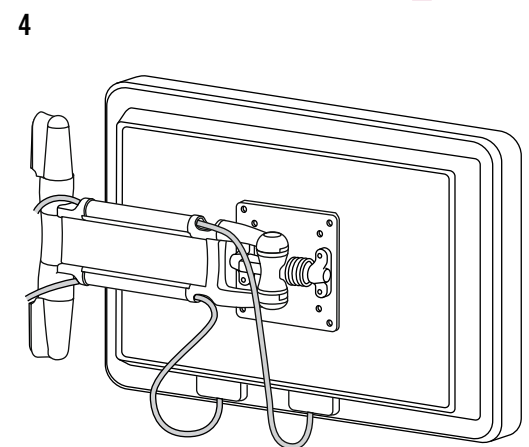
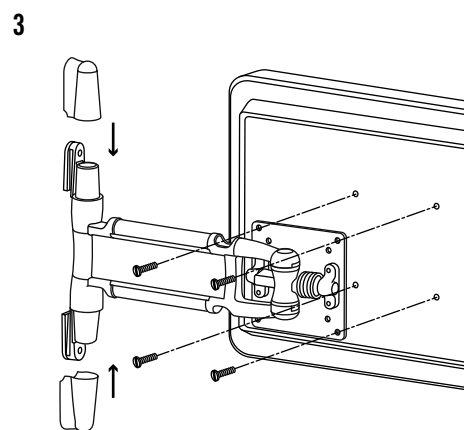
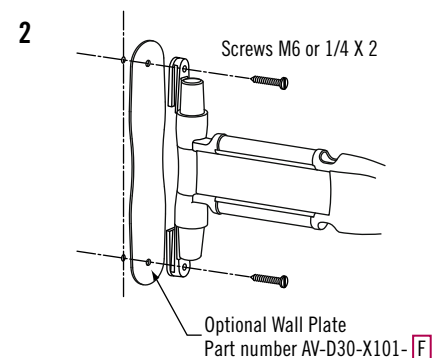
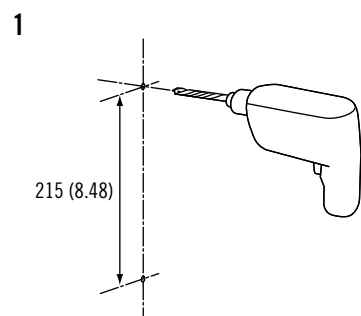

For complete installation and operation instructions please consult the product manual included in every package or available to download from www.southco.com

Dimensions in millimeters (inch) unless otherwise stated

Global Corporate Headquarters and Americas Customer Service & Technical Support Center
Concordville, PA – USA · Tel: (1) 610-459-4000 · Fax: (1) 610-459-4012



www.southco.com/AV

Southco® AV ARM NA 10-09

southco
CONNECT · CREATE · INNOVATE



AV Series Dynamic Mounting Arm

Tilt and Swivel, Single Arm, Locking

- Intuitive grab and move operation enhances the user experience**

No knobs or tools required to reposition the display

Precise control of operating effort ensures ideal “feel” and eliminates “drift”

Holds securely, even in applications with dynamic loading

- Locking mechanism in stowed position**

- Low profile in the stowed position**

Folds to within 50 mm of the wall

- Snap-open channels simplify wire management**

Easy display installation and replacement

- Factory assembled and ready for use**

Product Detail

Wire channel in open position.

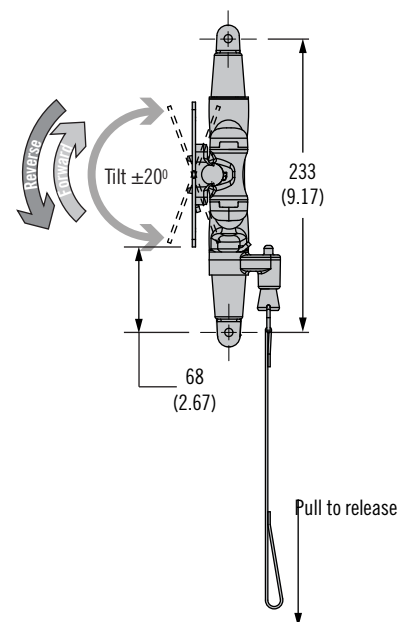
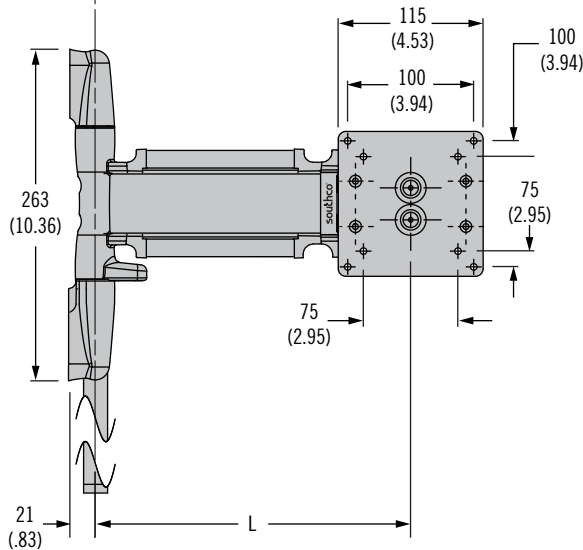
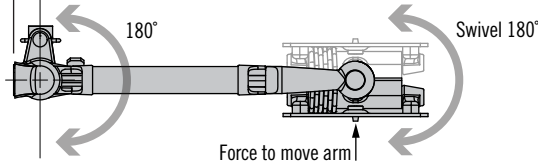
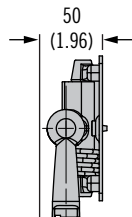
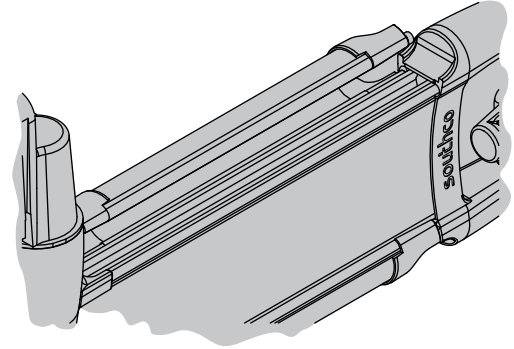
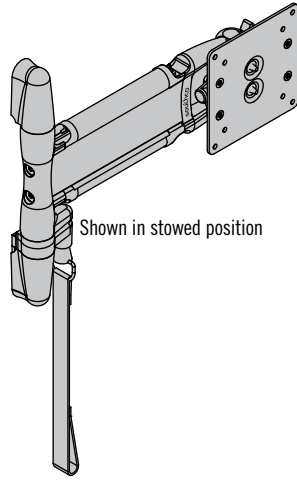

VESA MIS-D, 100, C



www.southco.com/AV

Dimensions in millimeters (inch) unless otherwise stated

southco
CONNECT · CREATE · INNOVATE

AV Series Dynamic Mounting Arm

Tilt and Swivel, Single Arm, Locking



Specification and Selection

Step 1

Determine display weight and distance (d) from mounting surface to center of gravity.

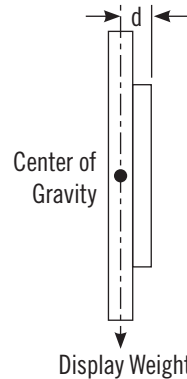

Step 2

Use chart below to select model (101, 102 or 103).

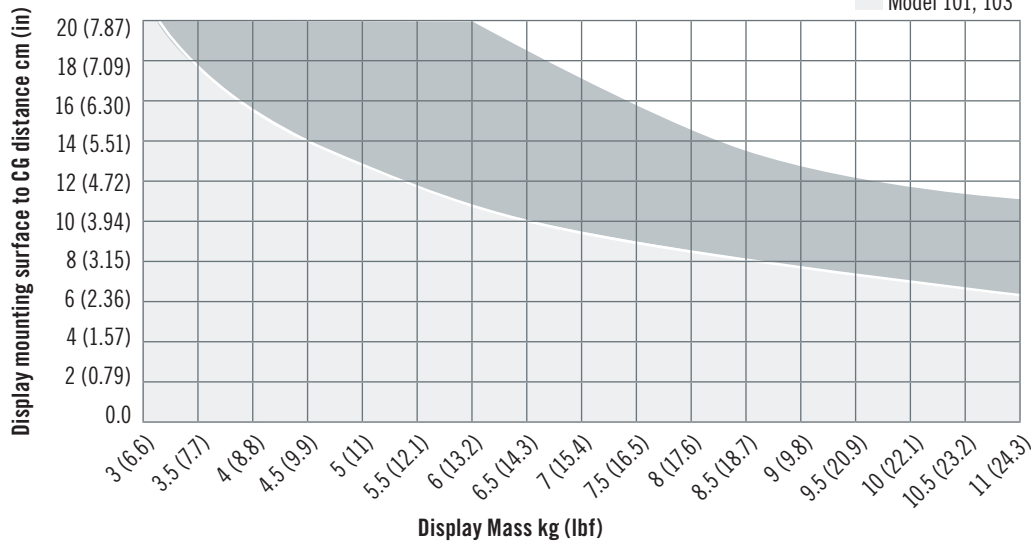

Step 3

Complete part number by selecting length and color options below.

K	Length (L)	Average ultimate load N (lbf)	
15	150 (5.9)	2000 (450)	
25	250 (9.8)	1200 (270)	
35	350 (13.8)	850 (190)	
45	450 (17.7)	660 (150)	

Model S	Force to move arm N (lbf)	Tilt Torque N•m (in lbf)		Swivel Torque N•m (in lbf)
		Reverse	Forward	
101	22.2 (5)	7.9 (70)	1.13 (10)	2.3 (20)
102	33.8 (7.6)	15.4 (136)	2.26 (20)	3.4 (30)
103	33.8 (7.6)	8.6 (76)	6.0 (53)	3.4 (30)

F	Color
50	Black
76	White

AV - D30 - K AC S - F

- Smooth operation enhances the user experience
- Adjust the display without knobs or tools
- Holds securely in every position

Material and Finish

Aluminum alloy, powder coated

Performance Details

Cycle performance: 20,000 cycles within $\pm 20\%$ of static torque specification

Max. dynamic working load:

Model 101, 103: 66N (15 lbf)

Model 102: 98N (22 lbf)

Average ultimate load: See table

Part Number

See table

Part Number Example

AV-D30-25AC101-50 = Dynamic mounting arm, Model 101, 250mm Length, black, locking

Southco Performance and Application Guidelines are supplied as general guides only, as conditions vary with each application and installation method. Represented cycle performance is not a guarantee of reliability under actual usage conditions in end user product applications. Users must test potential product solutions under the actual application conditions and environment to determine suitability of the product for the purpose and function intended by the user and to assure desired performance.



AV Series Dynamic Mounting Arm

Tilt and Swivel, Single Arm, and Double Arm

- **Intuitive grab and move operation enhances the user experience**
No knobs or tools required to reposition the display
Precise control of operating effort ensures ideal “feel” and eliminates “drift”
Holds securely, even in applications with dynamic loading
- **Consistent repeatable operation**
- **Fully enclosed for optimum cleanability**
- **Snap-on wire management cover**
- **Factory assembled and ready for use**

Tilt and Swivel

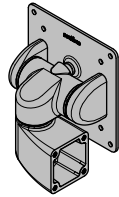

Single Arm

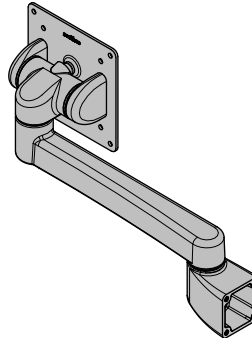

Double Arm

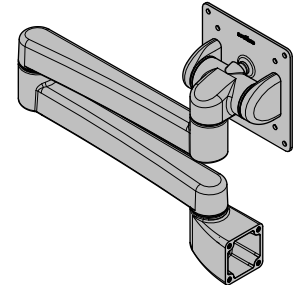

Mounting Options

Wall Mount

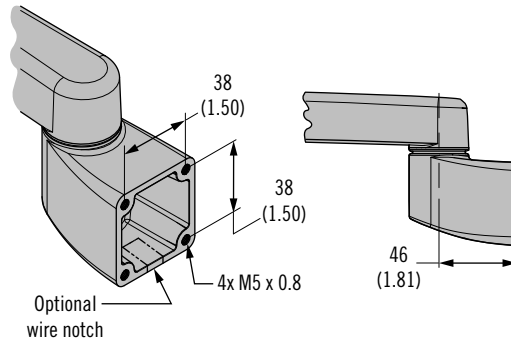
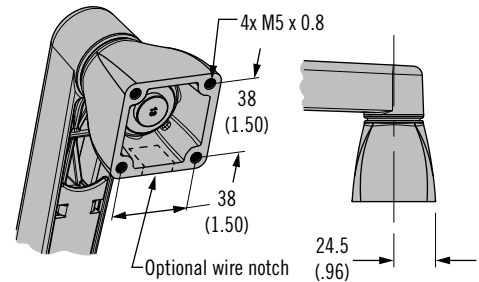
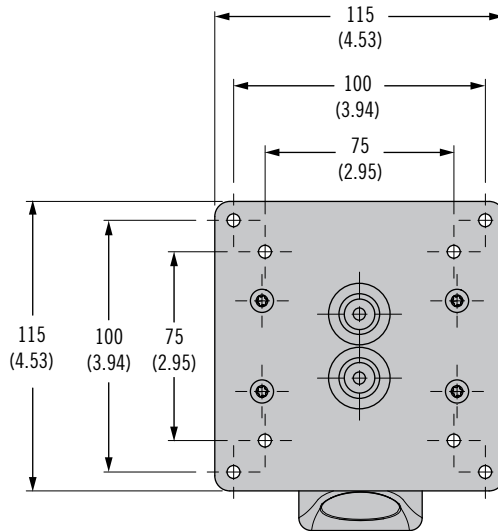

Table Mount



Display Mounting Plate



VESA MIS-D, 100, C

Other options available. For complete details on variety, part numbers, installation and specification, go to



www.southco.com/AV

Dimensions in millimeters (inch) unless otherwise stated

southco
CONNECT · CREATE · INNOVATE

AV Series Dynamic Mounting Arm

Tilt and Swivel, Single Arm, and Double Arm



Tilt and Swivel

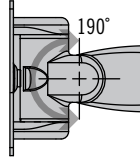

Single Arm

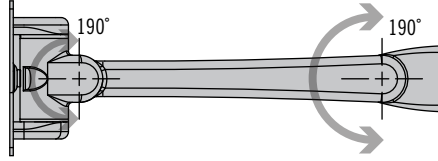

- Smooth operation enhances the user experience
- Adjust the display without knobs or tools
- Holds securely in every position

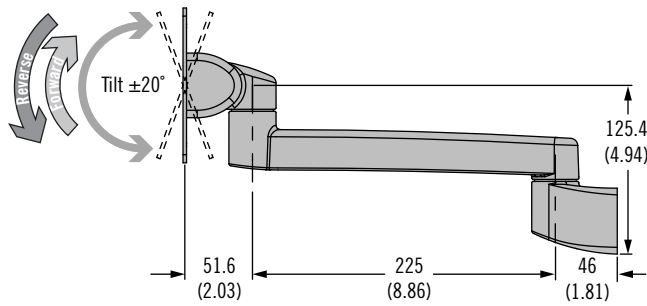
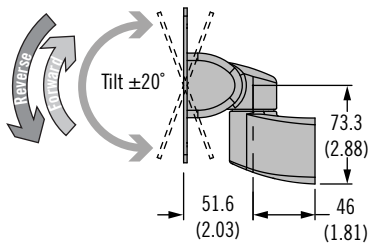

Double Arm

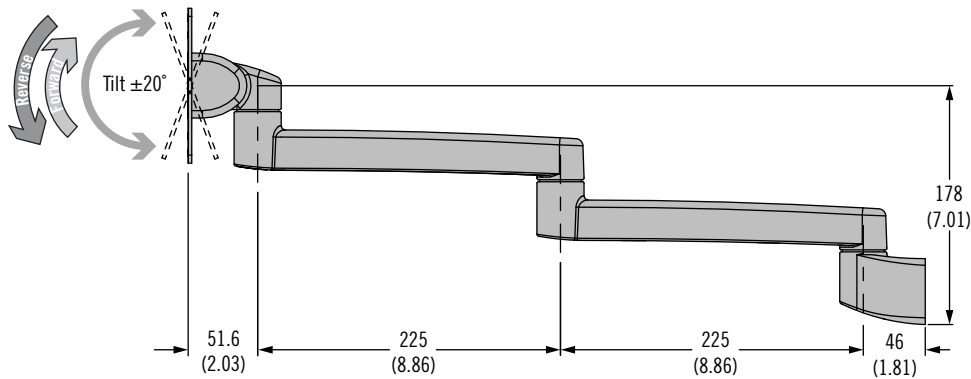
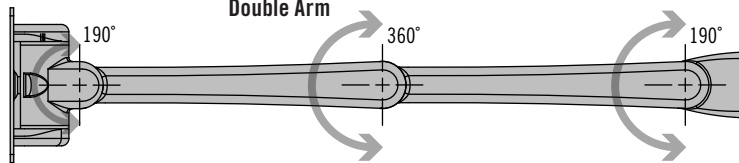

Other options available. For complete details on variety, part numbers, installation and specification, go to



www.southco.com/AV



AV Series Dynamic Mounting Arm

Tilt and Swivel, Single Arm, and Double Arm

Material and Finish

Aluminum alloy, powder coated

Performance Details

Cycle performance: Guaranteed for 20,000 cycles. See trade drawing for details.

Note: Double Arm not recommended for displays over 5.4 kg (12 lb)

Max. dynamic working load:

Model 101, 103: 70N (15.7lbf)

Model 102: 100N (22.5lbf)

Average ultimate load:

Tilt/Swivel: 1845N (415lbf)

Single Arm: 1715N (385lbf)

Double Arm: 880N (195lbf)

Specification and Selection

Step 1

Determine display weight and distance (d) from mounting surface to center of gravity.

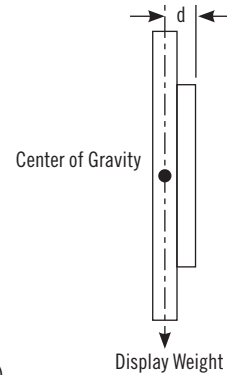

Step 2

Use chart below to select model (101, 102 or 103).

Note: Double Arm not recommended for displays over 5.4 kg (12 lb)

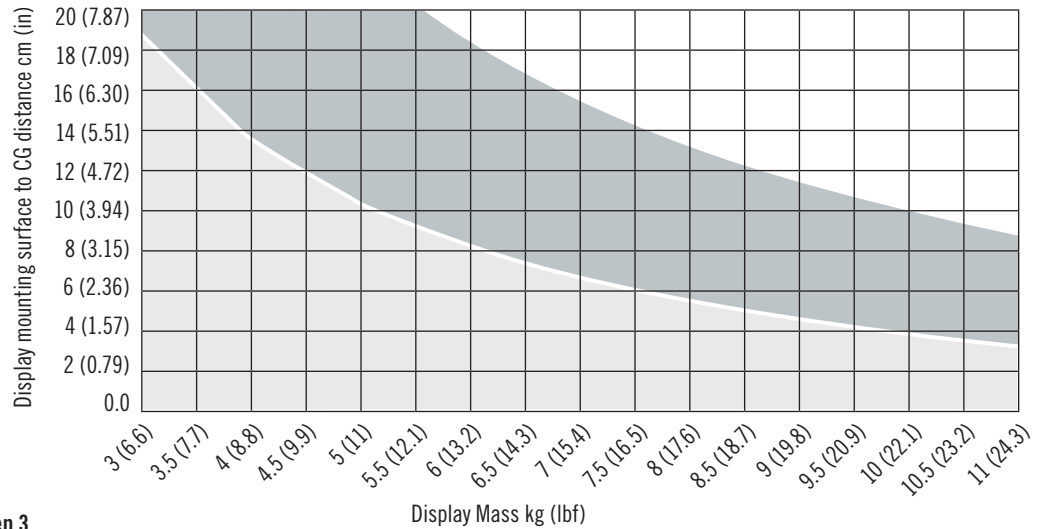

Step 3

Complete part number by selecting length and color options below.

Style	Model	Tilt Torque N-m (in-lbf)		Swivel Torque N-m (in-lbf)			Part Number			
		Reverse	Forward	At Display Mount	At Wall Mount	Center Joint	Wall Mount		Table Mount	
							No Notch	Wire Notch	No Notch	Wire Notch
Tilt and swivel	101	7.9 (70)	1.13 (10)	4.3 (38)	N/A	N/A	AV-D32-10K101-XX	AV-D32-10K111-XX	AV-D32-10K121-XX	AV-D32-10K131-XX
	102	15.4 (136)	2.26 (20)	4.3 (38)	N/A	N/A	AV-D32-10K102-XX	AV-D32-10K112-XX	AV-D32-10K122-XX	AV-D32-10K132-XX
	103	8.6 (76)	6.0 (53)	4.3 (38)	N/A	N/A	AV-D32-10K103-XX	AV-D32-10K113-XX	AV-D32-10K123-XX	AV-D32-10K133-XX
Single arm	101	7.9 (70)	1.13 (10)	4.3 (38)	9.8 (87)	N/A	AV-D32-23A101-XX	AV-D32-23A111-XX	AV-D32-23A121-XX	AV-D32-23A131-XX
	102	15.4 (136)	2.26 (20)	4.3 (38)	9.8 (87)	N/A	AV-D32-23A102-XX	AV-D32-23A112-XX	AV-D32-23A122-XX	AV-D32-23A132-XX
	103	8.6 (76)	6.0 (53)	4.3 (38)	9.8 (87)	N/A	AV-D32-23A103-XX	AV-D32-23A113-XX	AV-D32-23A123-XX	AV-D32-23A133-XX
Double arm	101	7.9 (70)	1.13 (10)	4.3 (38)	9.8 (87)	9.8 (87)	AV-D32-46D101-XX	AV-D32-46D111-XX	AV-D32-46D121-XX	AV-D32-46D131-XX
	102	15.4 (136)	2.26 (20)	4.3 (38)	9.8 (87)	9.8 (87)	AV-D32-46D102-XX	AV-D32-46D112-XX	AV-D32-46D122-XX	AV-D32-46D132-XX
	103	8.6 (76)	6.0 (53)	4.3 (38)	9.8 (87)	9.8 (87)	AV-D32-46D103-XX	AV-D32-46D113-XX	AV-D32-46D123-XX	AV-D32-46D133-XX

Part Number Example

AV-D32-23A101-50 =

Single arm, Model 101, wall mount, no wire notch, black

Other options available. For complete details on variety, part numbers, installation and specification, go to



www.southco.com/AV

For tilt version, see Southco AV Arm section.

XX	Color
50	Black
76	White

Dimensions in millimeters (inch) unless otherwise stated

southco
CONNECT · CREATE · INNOVATE

AV Series Dynamic Mounting Arm

Tilt and Swivel, Single Arm, and Double Arm



Installation

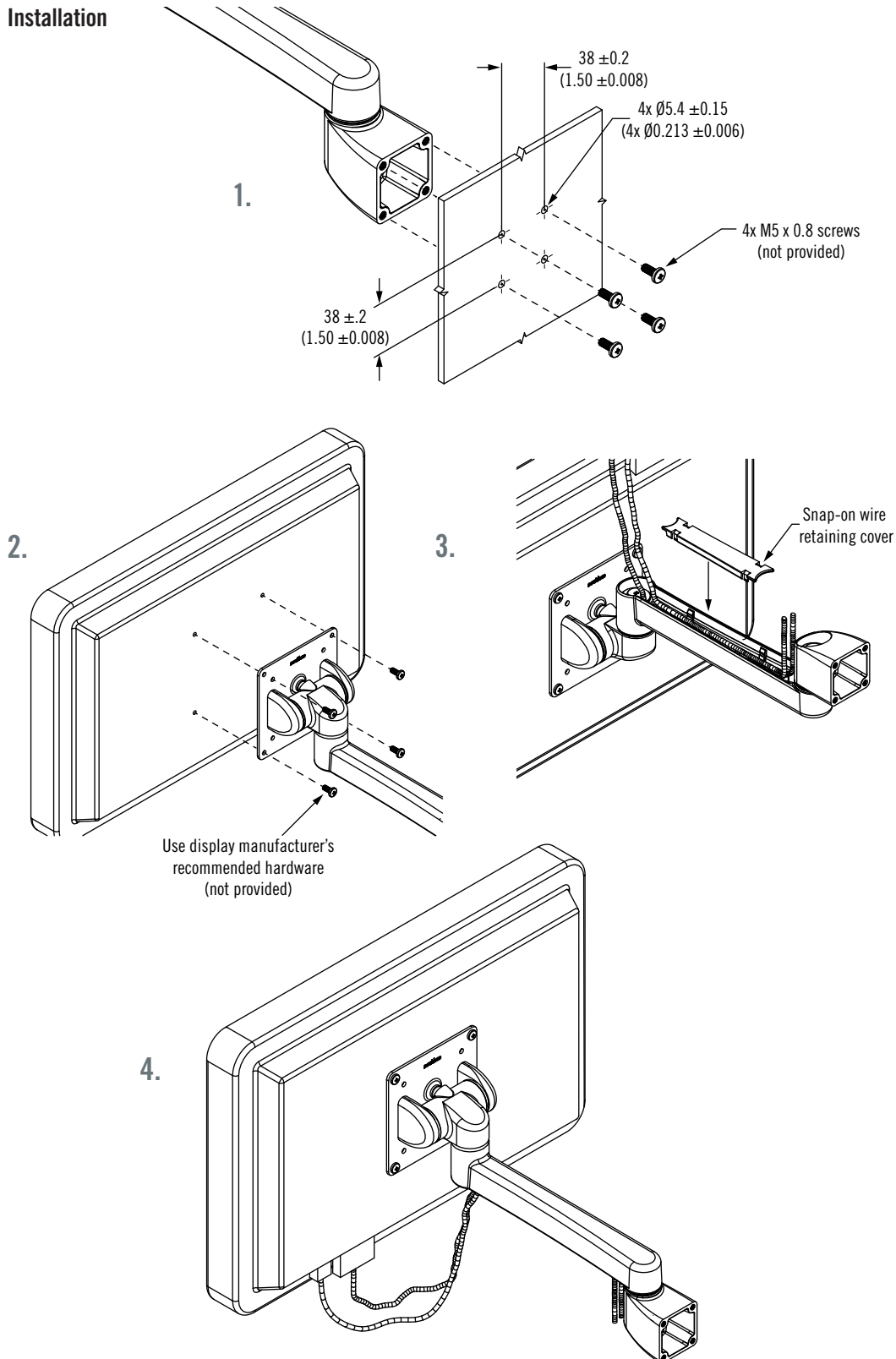

Dimensions in millimeters (inch) unless otherwise stated

- Smooth operation enhances the user experience
- Adjust the display without knobs or tools
- Holds securely in every position